

CONSTRUCTION NOTES

Obtain Construction Plans from Designer prior to starting job.
 Coordinate with Contractor / Engineering Firm for exact locations of proposed structures and facilities prior to installation of gas facilities.
 Install new main as shown or as directed in field at time of installation. Contact Engineering for approval of field generated changes.
 Long side mains and services to be installed below proposed sub-cuts (See Construction Plans).
 All test points should be installed in the boulevard or other acceptable locations and avoid placement in driving lanes.
 Verify Coating test results if required prior to abandoning main.
PIPELINE MARKERS:
 Contractor shall be responsible for installing pipeline markers per Natural Gas Operations Manual, Section 5.4
NOTE: BORE ALL PAVED STREETS AND DRIVEWAYS
 Minimum depth requirements for crossings of state highways and county roads is 60". Minimum depth requirements for crossings of city streets and township roads is 48".
 Minimum depth for parallel installations on state highways and county roads is 36". Minimum depth for parallel installations on city streets and township roads is 30". All steel pipe welds to be coated with 2 part epoxy.
 2" STL CL-5 (F4251994) IS TO BE REMOVED FROM UNDERSIDE OF BRIDGE FOLLOWING MAIN ABANDONMENT.
 ALL PIPE IS TO BE DISPOSED OF BY CENTERPOINT ENERGY. CONTACT MADDIE NIERENGARTEN (612-321-5469) TO COORDINATE DISPOSAL AND ROLL AWAY.
 REFER TO PACKET FOR PIPE REMOVAL PROCEDURES.

CONSTRUCTION PROCEDURES

Install, Clean and Test; and Put in Service; Proposed new main per CenterPoint Energy Construction and Services Manual.
 Procedure for tapping or making tie-ins to existing gas mains: Verify existing gas main size, type, and location prior to tapping or making tie-in. Monitor and verify, using a pressure gauge, existing gas main Pressure Class within the bell hole of tap location or tie-in location prior to tapping or making tie-in.
 Purge new main until essentially 100% reading is obtained on Combustible Gas Indicator. See CenterPoint Energy Construction and Service Manual Section CS-B-1.230 for purging mains into service.
 Complete all Service / Meter Work as directed. (See Service Survey)
 See Abandonment Procedures for abandonment and purging procedures.
 Install a marker ball at a new end of main, at a valve, at each ell of a horizontal offset, at road crossings and at any fitting or pressure control identified as needing to be located in the future. Refer to CenterPoint Energy Construction and Service Manual section CS-B-1.310 for installation procedures.
Pipe ≤ 4-Inches Diameter (Unregulated PCB area):
 Project area cleared for internal impacts. Pipe being removed is unregulated for disposal if coating does not exist or is non-asbestos. Refer to CNIP Construction and Service Manual CS-B-1.110, CS-B-1.130, and CS-B-1.100, for pipe to be abandoned.
 When butt fusing to existing in-service polyethylene, visually inspect for the presence of hydrocarbon permeation immediately after removing fusion iron. If any bubbling is identified on the heated surface, do not join to new PE pipe. Allow to cool and cut this end off (12" length) and send to the Golden Valley Lab with street location and W.O.#. Complete tie-in/extension using an electrofusion coupling(s).
 Document in field notes.

ABANDONMENT PROCEDURES

See Construction Procedures for installation of mains and services prior to abandonments.
 The project includes work on one-way feed mains.
 Ensure all proposed main is in service, all taps are completed
 And all services have been transferred to new main prior to abandonments.
 Cut and abandon existing main as shown. Purge abandoned mains until essentially 0% gas reading is obtained on Combustible Gas Indicator. See CenterPoint Energy Construction and Services Manual Section CS-B-1.110 and Section CS-B-1.230 for purging mains out of service using air movers.
CROSS COMPRESSION SHALL BE USED TO LOWER PRESSURE IN LINE PRIOR TO VENTING TRAPPED GAS AND PURGING LINE OUT OF SERVICE. IF CROSS COMPRESSION CANT BE USED, CONTACT ENGINEERING.
Warning - cross compression into a one-way feed system requires Engineering approval. Trapped gas to be transferred to CL-5 (20) PSIG system.
 Do not exceed 20 PSIG on the outlet side of the Cross Compression unit. Monitor using digital gauge on outlet side of unit.
 Contact Area C&M Personnel prior to starting job to review Cross Compression process and to arrange field support.
 For typical connection of Cross Compression:
 Plastic Mains: Use a 1-1/4" PE Service Tee with a temp. 1-1/4" anodeless riser with valve
 Steel Mains: Use a 2" TOR Drill Nipple.
 Contact Engineering with questions.

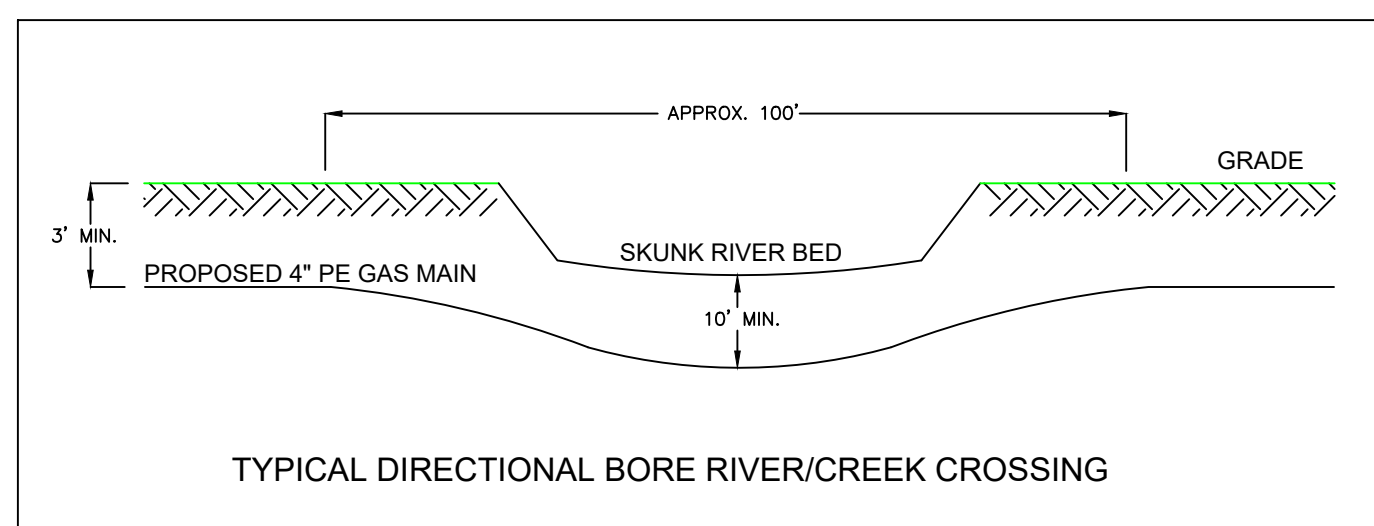

CenterPoint Energy

PROPRIETARY AND CONFIDENTIAL

PROJECT #: 120875637

CITY: PIERZ

COUNTY: MORRISON

LEGEND:

- IN SERVICE
- PROPOSED
- PROPOSED ABANDONED
- ABANDONED
- NOT A PART OF PROJECT
- SEE NOTES

Pipe Summary

335'	4" PE Class 5
335'	TOTAL PIPE
Proposed Abandoned Pipe	
89'	2" STL Class 5
232'	2" TR Class 5
321'	TOTAL PIPE

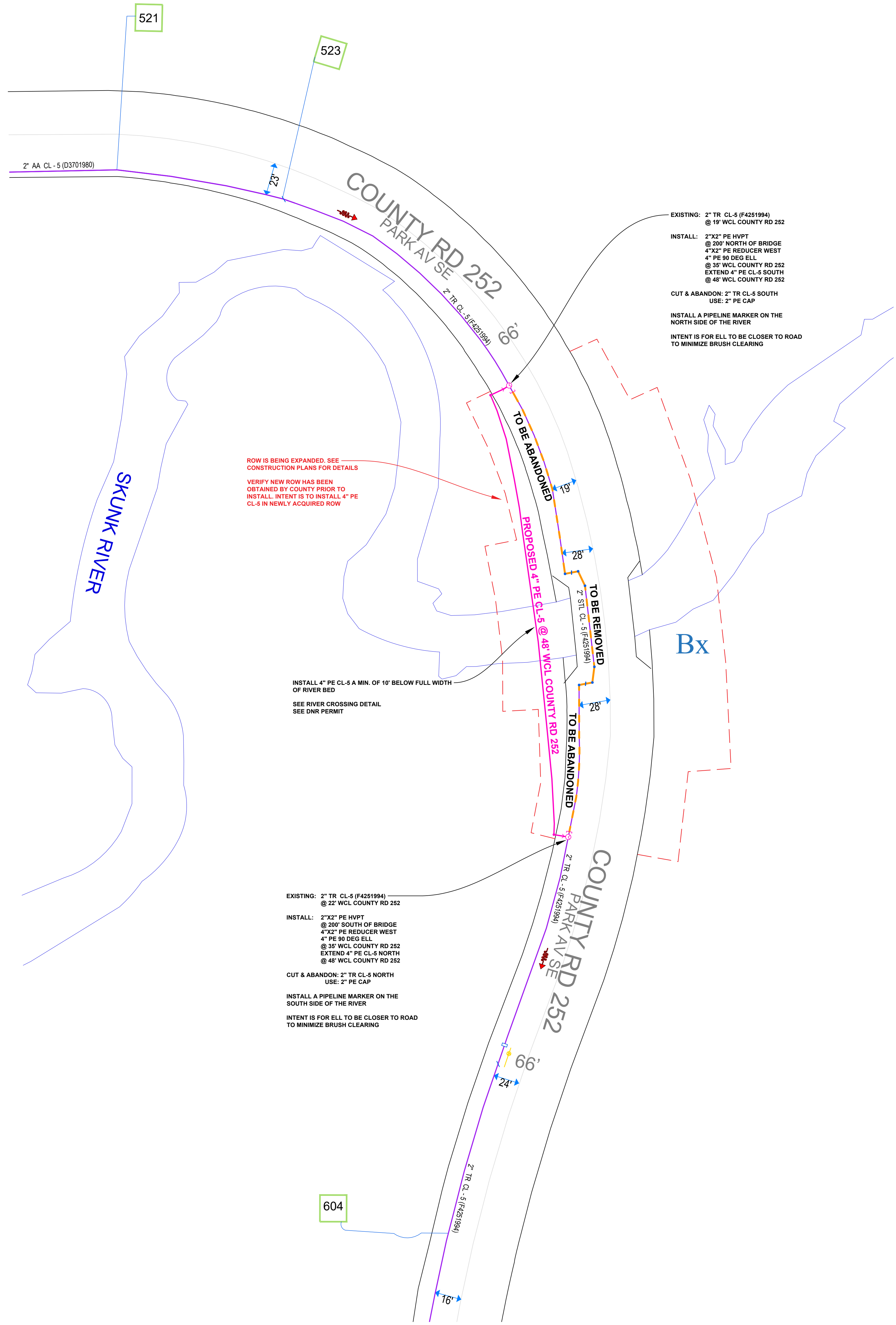

EXISTING: 2" TR CL-5 (F4251994) @ 19' WCL COUNTY RD 252

INSTALL: 2"x2" PE HVPT @ 200' NORTH OF BRIDGE
 4"x2" PE REDUCER WEST
 4" PE 90 DEG ELL
 @ 35' WCL COUNTY RD 252
 EXTEND 4" PE CL-5 SOUTH
 @ 48' WCL COUNTY RD 252

CUT & ABANDON: 2" TR CL-5 SOUTH
 USE: 2" PE CAP

INSTALL A PIPELINE MARKER ON THE NORTH SIDE OF THE RIVER

INTENT IS FOR ELL TO BE CLOSER TO ROAD TO MINIMIZE BRUSH CLEARING

INSTALL 4" PE CL-5 A MIN. OF 10' BELOW FULL WIDTH OF RIVER BED
 SEE RIVER CROSSING DETAIL
 SEE DNR PERMIT

EXISTING: 2" TR CL-5 (F4251994) @ 22' WCL COUNTY RD 252

INSTALL: 2"x2" PE HVPT @ 200' SOUTH OF BRIDGE
 4"x2" PE REDUCER WEST
 4" PE 90 DEG ELL
 @ 35' WCL COUNTY RD 252
 EXTEND 4" PE CL-5 NORTH
 @ 48' WCL COUNTY RD 252

CUT & ABANDON: 2" TR CL-5 NORTH
 USE: 2" PE CAP

INSTALL A PIPELINE MARKER ON THE SOUTH SIDE OF THE RIVER

INTENT IS FOR ELL TO BE CLOSER TO ROAD TO MINIMIZE BRUSH CLEARING

COPIES:
 PIPELINE INTEGRITY PACKET: N
 STATION MANAGER: N
 DD NUMBER: N/A
 CORROSION: ROSS BARKER
 EMP: N

SITE CONTACT:
 JOHN KOSTREBA
 John.Kostreba@MorrisonCountyMn.Gov
 320-333-5084

SURVEYOR REQUIRED? Y

RETURN PACKET TO ENG? N

JOB BRIEFING REQUIRED? Y

GFP #: N/A

PERMITS: MORRISON COUNTY
 DNR

PROJECT DESCRIPTION: SREL
 CR 252 BRIDGE REPLACEMENT

DESIGNER: MORGAN ARCH
 PHONE#: 612-554-7367
 DRAWN BY: MORGAN ARCH
 DESIGN DATE: 06/30/2026

REVISION INFO:

MAIN	SCALE: 1"=40'
SS#: #	SHEET 1 OF 1

I hereby certify that this plan, specification, or report was prepared by me or under my direct supervision and that I am a duly Licensed Professional Engineer under the laws of the state of Minnesota.

Signature: *[Signature]*

Typed or Printed Name: DANIEL G. CHRISTENSEN

Date: 07/02/2026 License Number: 46588